

1310/1550nm DFB LC TOSA

Features

(MQW DFB) Laser Design
 Low threshold current
 Built-in InGaAsP monitor PD
 Cost-effective Uncooled Laser Technology
 5.6-mm TO-style package

Applications

CATV Return-Path
 Analog transmission
 Light source
 FTTX

Absolute Maximum Ratings

Parameter	Symbol	Min.	Max.	Unit	Test condition
Storage temperature	Tst	-40	+100	°C	-
Operating temperature	Top	-20	+70	°C	-
Reverse voltage	VR		2	V	CW
Laser forward current	If	-	-	120	mA
Soldering temperature/time			260/10	°C/S	-

Optical & electrical characteristics

Parameter	Symbol	Min.	Typ.	Max.	Unit	Test Conditions
Optical Output Power	Po	0.5	-	2.0	mW	CW
Threshold Current	Im	-	10	30	mA	T=25°C
		-	35	60		T=85°C
Operating Current	Iop	-	20	30	mA	CW, Po=2mW, T=25°C
		-	35	75		CW, Po=2mW, T=85°C
Forward Voltage	VF	-	1.1	1.6	V	Po=2mW
Center Wavelength	λ_c	1290	1310	1330	nm	Po=2mW, CW
		1530	1550	1570		
Spectral Width(-20dB)	$\Delta\lambda$	--	0.1	1.0	nm	Po=2mW
Monitor Dark Current	ID	-	-	1000	nA	Vrpd=5V
Optical Isolation	ISO	30	-	-	dB	
Modulation Bandwidth	BW	1.25	-	4.25	GHz	-3dB, Po=2mW

You can choose with Isolator or not.

Dimensions (mm) :

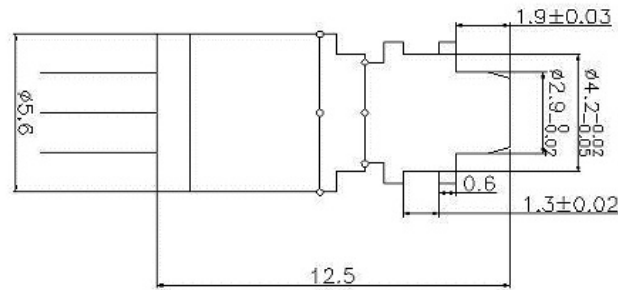

We can design the connector by your requirement.

Pin Assignment:

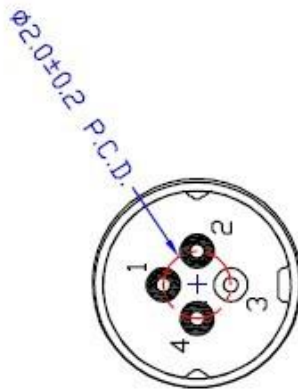

PIN	Type A
1	PD Cathode
2	PD Anode
3	LD Anode, CASE
4	LD Cathode

PIN	Type C
1	PD Anode
2	LD Anode, PD Cathode
3	CASE
4	LD Cathode

Order Information:

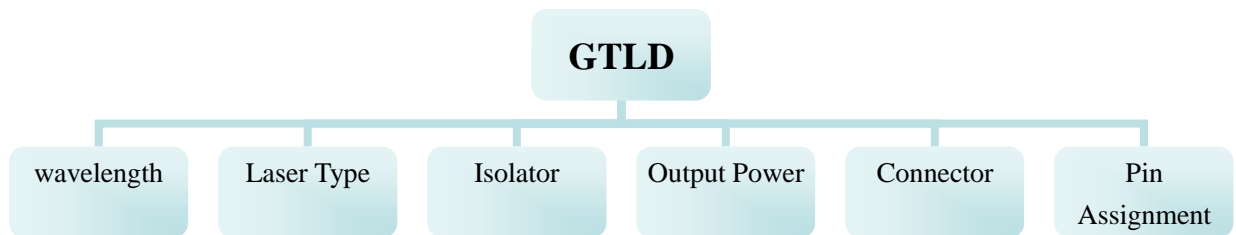

Wavelength	3:1310nm	5:1550nm	C: 1270nm-1610nm
Laser Type	DF:DFB		
Isolator	W:with	WO: without	
Output Power	0.5:0.5-1mW	1:1-2mW	2:2-3mW
Connector	LC		
Pin Assignment	A:A	C:C	